

Apartment living at its private
and exclusive best



Signature residences in **Central Kanpur**



GEETIKA KINGDOMS
A very British way of living



Presenting to you, Geetika Kingdoms, ultra-luxury homes set amidst lush landscaped gardens, in a style of British architecture. Rising 9 levels, the ultra modern 4 towers stand out as a new icon in the city.

The unique and balanced architectural composition has been carefully created to generate impressive views from every aspect of the building. Apartments are splendidly planned with enormous outdoor & indoor parking spaces, every eco friendly unit in The Geetika Kingdoms has been thoughtfully designed for you to relax, unwind & socialise in a British lifestyle.

It's a place that can be your dream home



Introducing



GEETIKA KINGDOMS
A very British way of living

ONLY
British Architectural
Apartments directly from
London to your city

First time in Uttar Pradesh

EXTERIORS:
British Heritage With Style

Artist Impression



Apartments tailored to provide you the
Highest Standards of Luxury from entrance itself

The planning and design of our luxurious apartments ensure an auspicious environment with highest standards of luxury. Your beloved family can embrace each new day confident in the blessings and good fortune to come home.







Green Living where Sustainability Meets Style

The apartment homes are constructed with the highest standards of sustainable materials, the idea of seamless connection with nature and also designed to integrate with natural lighting and ventilation.

The entire enclave is surrounded by lush green landscapes. The beauty of the adjoining Eco Park adds feather in the crown of The Geetika Kingdoms.



Artist Impression

Proposed Amenities

Leisure, recreational and convenience amenities offered at The Geetika Kingdoms

- | | |
|-------------------------|--------------------------------|
| ① Great Fall | (Welcome Fountain) |
| ② Flamingo Garden | (Leisure Park) |
| ③ Charlie Square | (Children & Kids Play Area) |
| ④ Shakespeare's Theater | (Open Air Theater) |
| ⑤ Body Titan | (The Indoor Gymnasium & Zumba) |
| ⑥ Olympian Field | (Open to Sky Fitness Center) |
| ⑦ Peace Park | (Meditation Park) |
| ⑧ The Royal Bath | (Pool & Pool Deck) |
| ⑨ Atlas Palace | (Grand Community Hall) |
| ⑩ Kingswood | (The Sports Center) |
| ⑪ Express Outlet | (Daily Needs Store) |



PEACE PARK - Yoga Park

Artist Impression



OLYMPIAN FIELD - Open Sky Fitness Center

Artist Impression

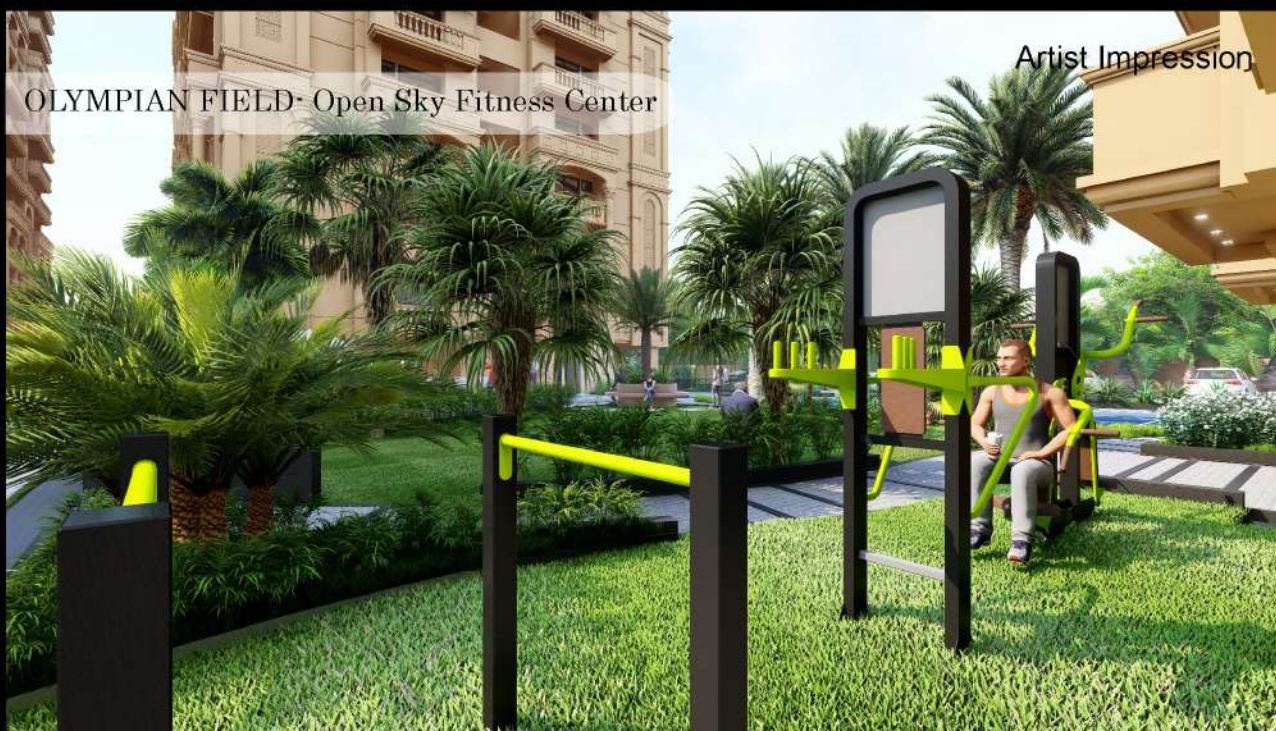

Embrace the indulgence your mind deserves

Our clubhouse offers an array of luxury amenities to please every age group whether you want to work out in the gym or de-stressing in a meditation park we provide all amenities in a single place.

BODY TITAN - The Indoor Gymnasium & Zumba

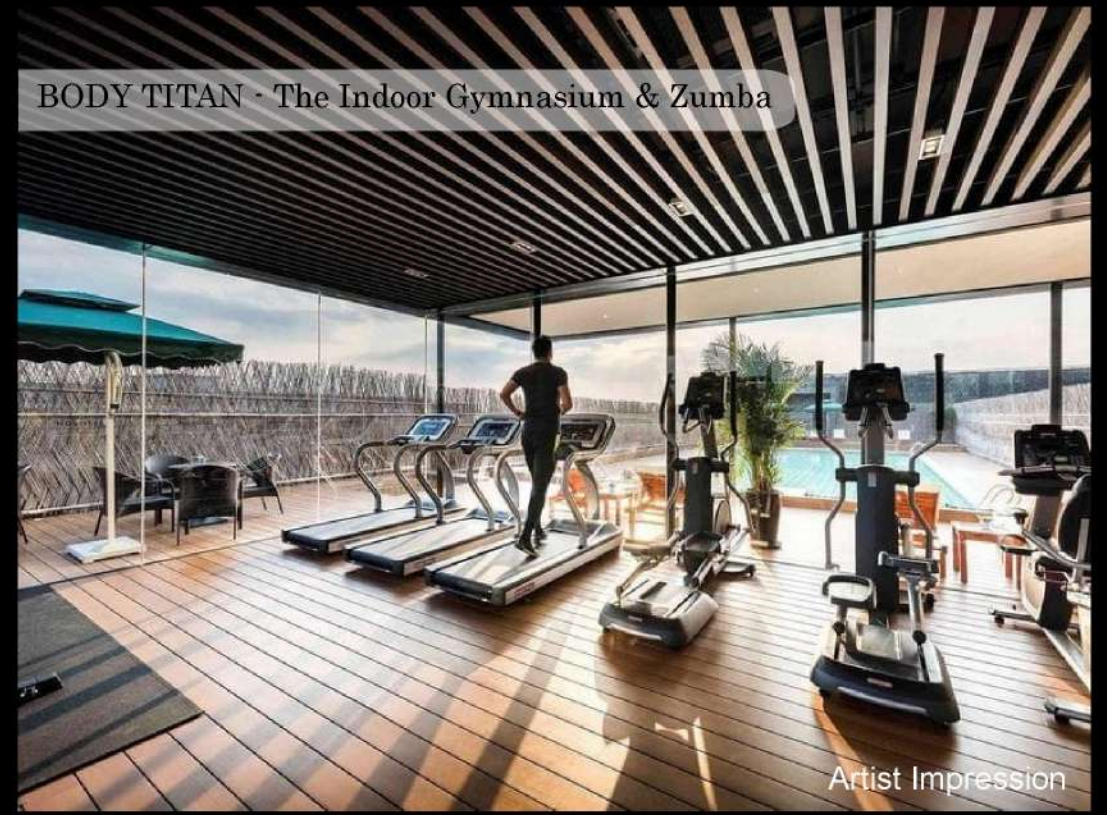

Artist Impression



SHAKESPEARE'S THEATER - Open Air Theater



Artist Impression

KIDS PLAY AREA



Artist Impression



19

Kingswood - The Sports Center

Make world class Sports infrastructure a part of your daily luxury lifestyle under one roof at The Geetika Kingdoms

- Badminton Court
- Skating Rink
- Table Tennis
- Billiards
- Chess
- Carrom Board
- Jogging Track





Proposed Amenities & Facilities in the Towers

- Landscaped Areas
- Rain water harvesting
- Sewage treatment plant
- Parking will be proper.
- Visitors' car parking
- Toilet for drivers
- Visitors' management system
- Guard Room at Entrance
- Staircases and elevators to rise high
- Fire-Fighting system as per NBC norms
- Over head tank for Water supply
- Transformer as required for power supply
- Solar lighting in certain Landscaped Areas
- CCTV and Intercom facilities will be provided in building
- Generator for lift, pump, common lights and 2 KVA backup for each flat
- Electric Vehicle charging point





Your Family is more secure with us

24X7 Security systems with centrally monitored CCTV cameras ensure safety of your family all the day long. Boom barriers make sure only those who truly belong may foot in.



Designs that make your eyes Sparkle

A Gateway towards opulent Lifestyle,
specially designed to glam up the style quotient.
Prepare your eyes to witness a grandeur experience
which you have never felt before

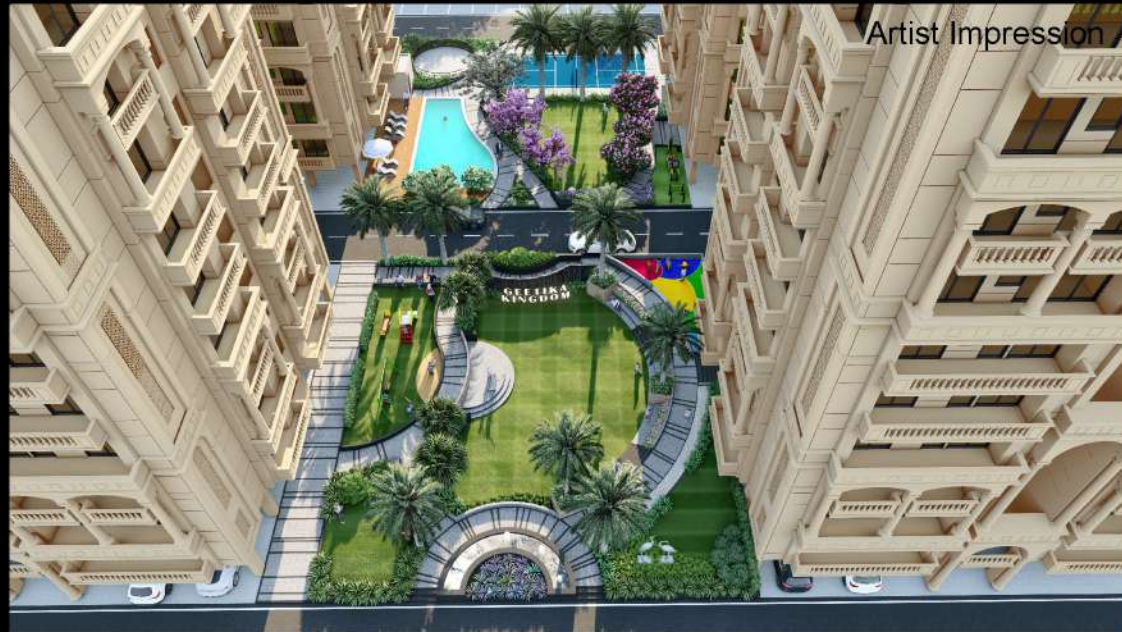



Four towers where
Prosperity is a way of
living and thinking

The Geetika Kingdoms is encircled by
4 beautiful towers.
Together, all four towers
will grant families an exclusive sense
of privacy with modern lifestyle.

Specification Within The Apartments



Foundation & Structure

Earth quake resistant R.C.C frame deigned by structural Designer (as per I.S. Code)

Door & Windows

External and internal flush doors with wood frame. All windows of aluminium/ upvc framing

POP & Painting

Standard design false ceiling with four LED panel lights in Drawing and Dining Room (Gypsum + Putty + Chalk)

Internal Finishing

Wall will be finished with JK / Birla or equivalent putty

Flooring

Drawing, dining and bed rooms will be covered by 2x4 vitrified tiles with 4" high skirting.

Elevation

Attractive exterior finished with apex or equivalent paint as per the elevation scheme

Lift

Branded like Schindler, Johnson etc

Electrical

Good quality concealed conduit wiring with copper twisted wire. Switches & Sockets of Havells/ Legrand or equivalent. All circuits protected by MCBs, T.V., A.C. and Telephone outlets in all rooms. Exhaust fan/ geezer point in each toilet & kitchen.

Plumbing

SW & SWR pipe with ISI mark will be used in sanitary lines and CPVC pipe ISI marked (finolex/ supreme/ ashirvad or equivalent) will be used in water supply lines

Kitchen

Semi modular kitchen of standard design with Granite top & S.S sink.

Toilets

Good quality of ceramic tile up to 7 ft. height, wall hang seat, wash basin & low level cistern shall be used.

Good quality fittings shall be used.

Branded Sanitary

Jaguar / Hindware / Cera or equivalent.

Type - A

(3 BHK)



Carpet Area- 78.83 Sq. Mtr.



Built-up Area- 100.86 Sq. Mtr.

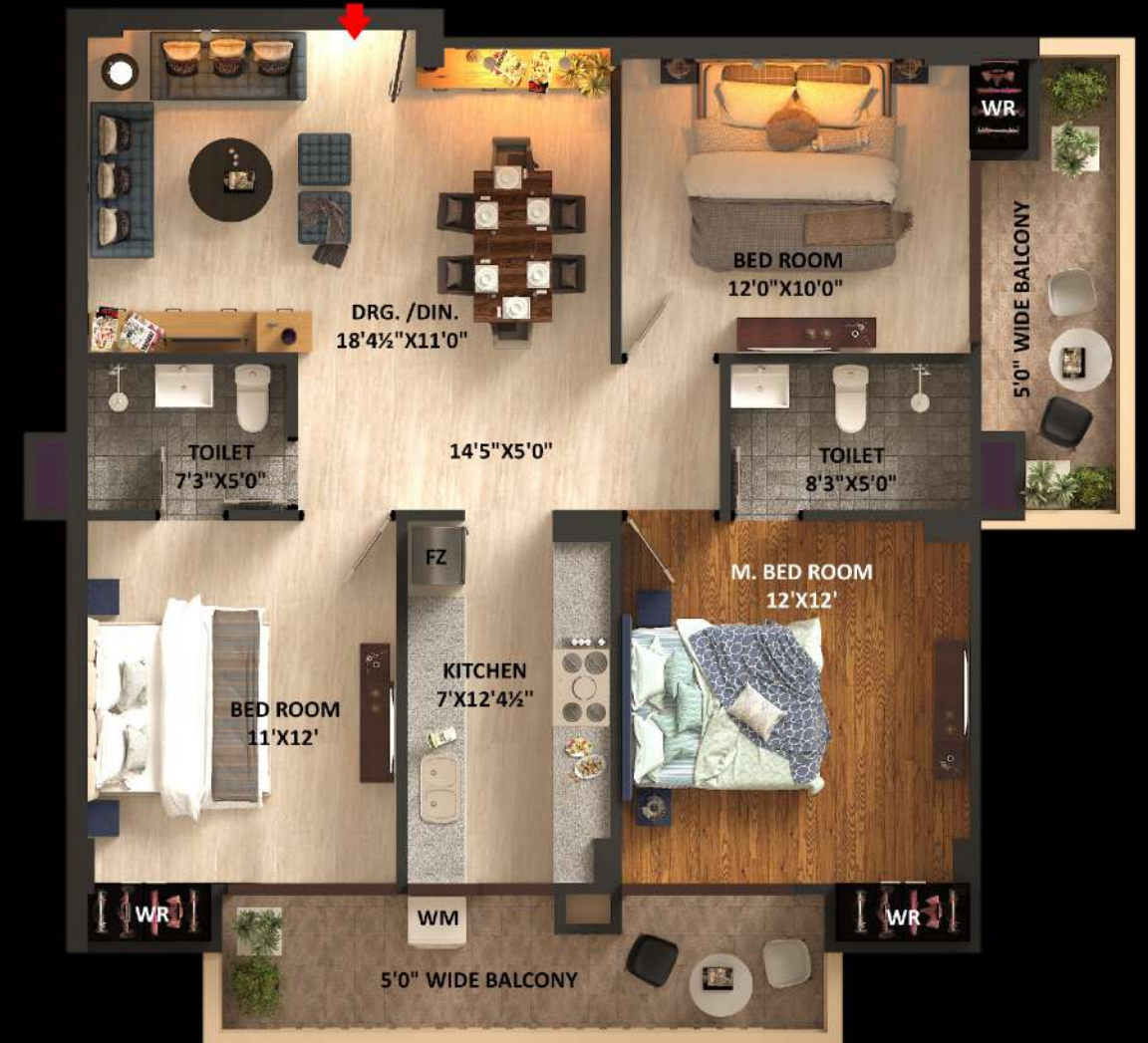

Type - B

(3 BHK)



Carpet Area- 88.10 Sq. Mtr.



Built-up Area- 107.51 Sq. Mtr.

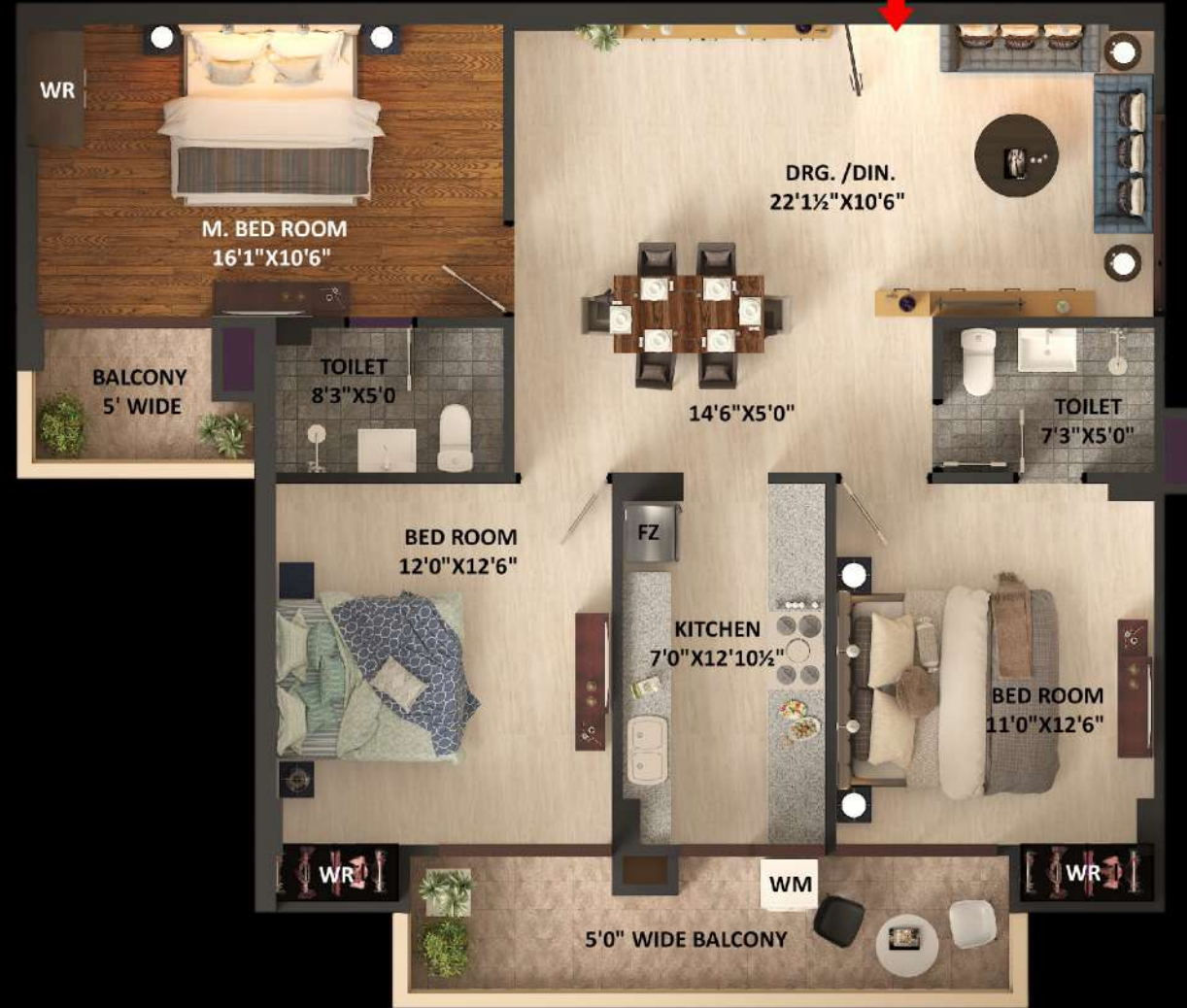

Type - C

(3 BHK)

Carpet Area- 80.66 Sq. Mtr.

Built-up Area- 101.66 Sq. Mtr.

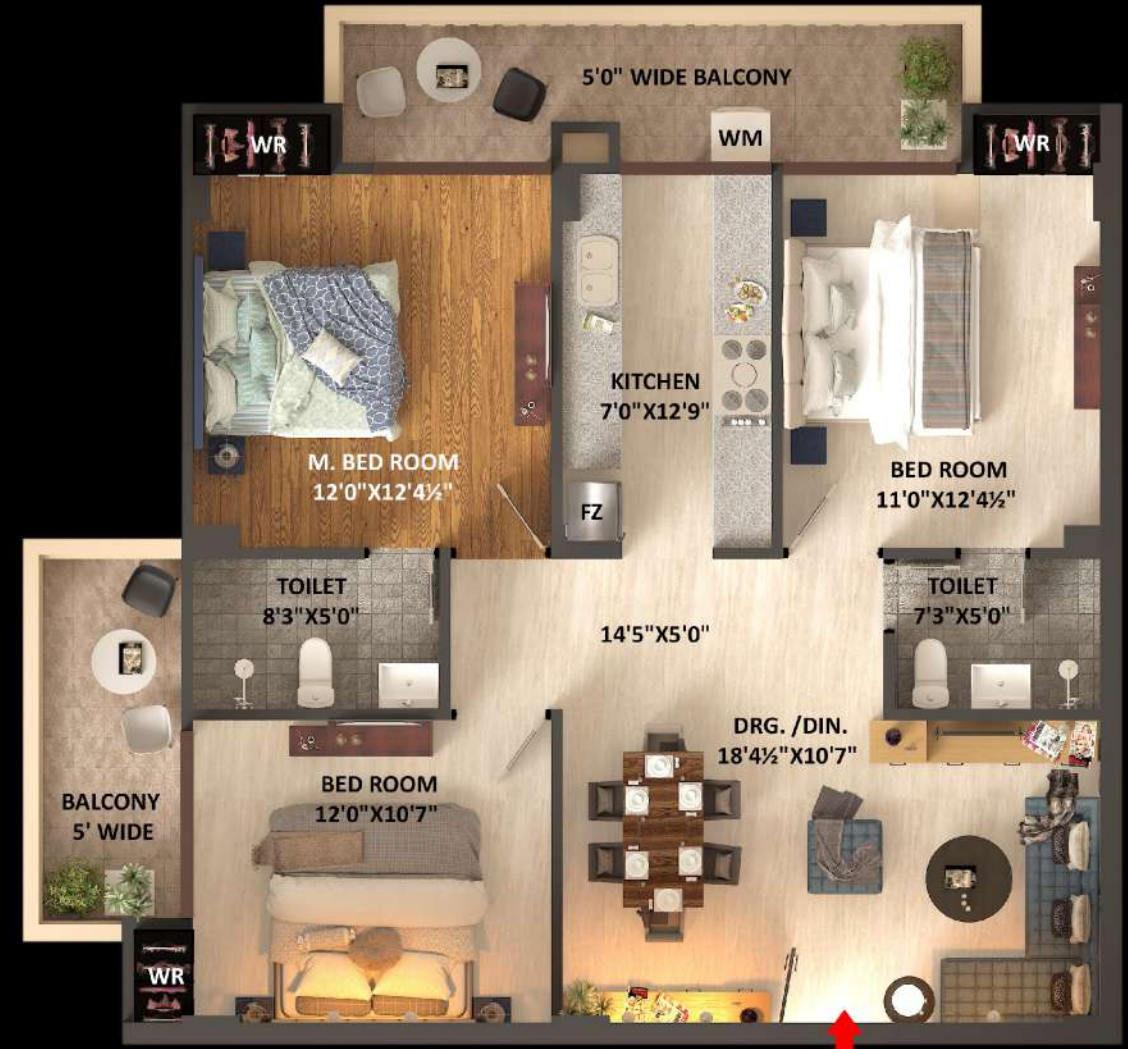

Type - D

(2 BHK)

Carpet Area- 70.90 Sq. Mtr.

Built-up Area- 93.63 Sq. Mtr.



Type - E

(3 BHK)

Carpet Area- 84.76 Sq. Mtr.

Built-up Area- 107.14 Sq. Mtr.







Artist Impression

GEETIKA KINGDOMS

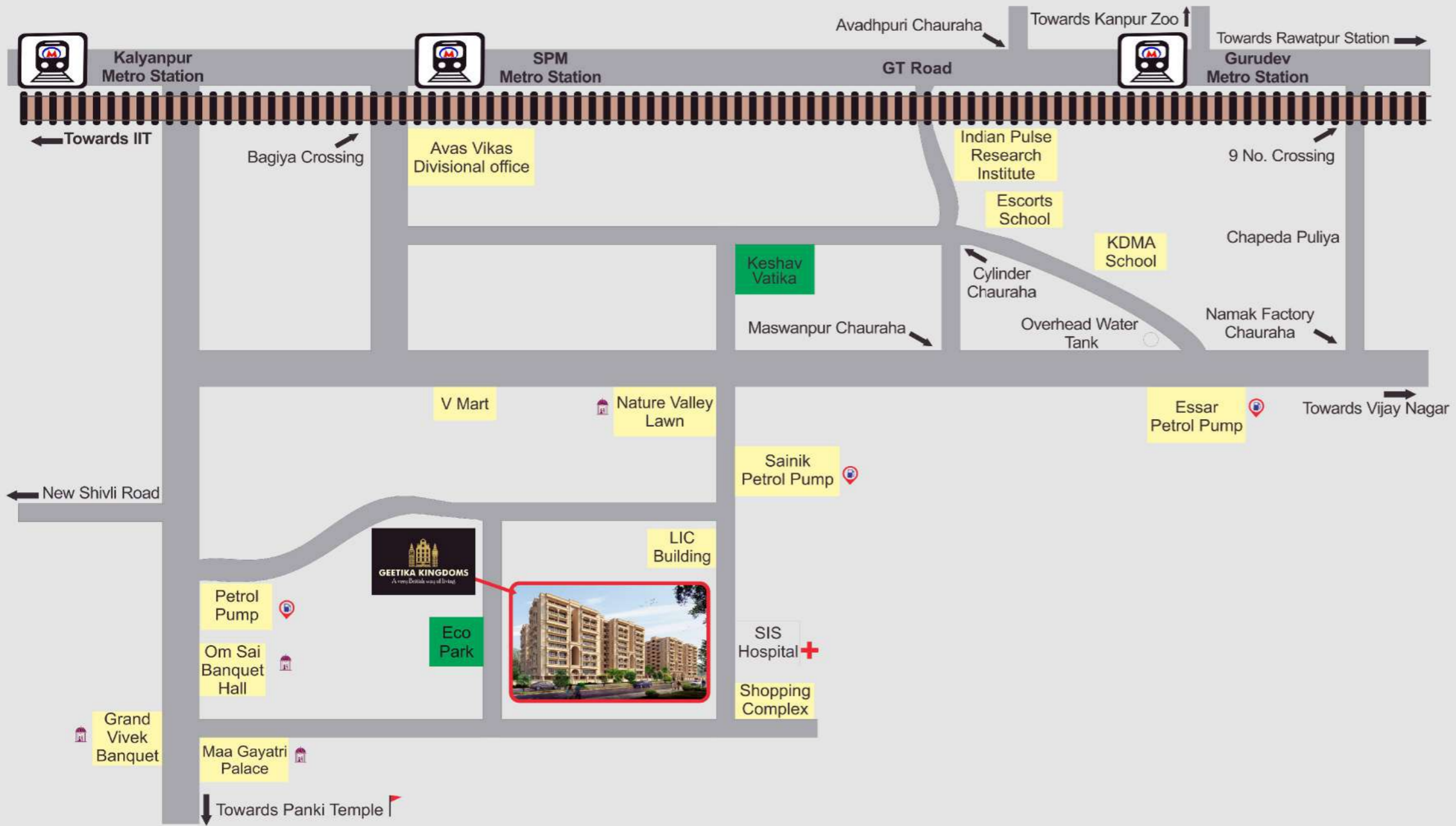
A very British way of living



Your neighborhood places needs and wants within easy reach, for every member of your family

	Eco Park Keshav Vatika	10 M 1.2KM
	SIS Hospital Apex Hospital	30 M 750 M
	Bachpan Play School K.D.M.A	850 M 3.4KM
	V Mart Rave Moti	1 KM 5.8 KM
	Lodheshwar Temple Panki Temple	1.3 KM 2.9 KM
	Kalyanpur Metro Station	3.0KM



Incepted in 2002, the Geetika Builders and Developers Private Limited today, is a strong, multifaceted, multi-disciplinary and vibrant organization, committed to delighting our clients through innovation. We strive to achieve the highest degree of technical excellence while maintaining the finest standards of business practices in all our endeavors.

Our prime motto is to provide client services followed by integrity, quality and reliability. Our motto have thus translated into good workmanship and helped us to fulfill dreams of our satisfied clients.

Geetika builders have earned a reputation for quality construction and inspiring design. Projects that stand testimony to their reputation are spread over Uttar Pradesh.

Landmark Projects in Kanpur





GEETIKA KINGDOMS

A very British way of living

Architect
Space Designer
Arun Kumar Sachan

geetikabuilders.in

Geetika Builders and Developers Private Limited

Site:	Plot no- GH-2, 3 Ambedkarpuram, Kanpur
Corporate office:	117/H-1/383, 1 st Floor Asthana Tower, Pandu Nagar, Kanpur
Contact:	8400520960, 9795481920
Email:	sales@geetikabuilders.in
UP RERA Registration No.:	UPRERAPRJ325813
RERA Website:	www.up-rera.in

"Images shown are for illustration purpose only. All illustrations and pictures are artist's impressions only. The image of the apartment shown are of the show apartment, we are offering for sale, un-furnished apartments and the add-ons such as furniture and fixtures in the marketing materials will not form part of any contract/ offer unless specifically incorporated in the Agreement for sale. The terms and conditions of sale shall be incorporated in the Agreement for sale only. While every care is taken in providing this information, the owner, the developer and managers cannot be held liable for variations. The items are subject to variations, modifications and substitutions as may be recommended by the company's architect and /or relevant approving authorities. The distance mentioned in location map are on approximate basis."

Terms & Conditions Apply, E&OE